



www.resexpo.com

# VU Case Rentals

iPBS 2016  
May 3-5, 2016

Deadline Date To Receive Discounted Rates:  
April 12, 2016

Please Mail, Email or Fax  
Completed Form to RES:

9291 West Bryn Mawr, Rosemont, IL 60018  
Email: customerservice@rosemontexpo.com  
Fax: 847-696-9797 • Phone: 847-696-2208

## VISION CASE

Full Vision Case Includes  
1-8" and 1-10" glass shelf with adjustable  
brackets, 26" high front glass display section

1/2 Vision Case Includes  
1-10" glass shelf with adjustable brackets,  
18" high front glass display section

1/4 Vision Case Includes  
12" high front glass display section

	QTY.	DISCOUNT	STANDARD	TOTAL
5 ft. Full Vision Case	_____	\$375.00	\$425.00	\$ _____
6 ft. Full Vision Case	_____	\$400.00	\$450.00	\$ _____
5 ft. 1/2 Vision Case	_____	\$375.00	\$425.00	\$ _____
6 ft. 1/2 Vision Case	_____	\$400.00	\$450.00	\$ _____
5 ft. 1/4 Vision Case	_____	\$375.00	\$425.00	\$ _____
6 ft. 1/4 Vision Case	_____	\$400.00	\$450.00	\$ _____



Full Vision Case

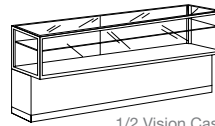

1/2 Vision Case

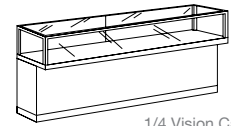

1/4 Vision Case

## CORNER VISION CASE

Full Corner Vision Case Includes  
1-8" and 1-10" glass shelf with adjustable  
brackets, 26" high front glass display section

1/2 Corner Vision Case Includes  
1-10" glass shelf with adjustable brackets,  
18" high front glass display section

1/4 Corner Vision Case Includes  
12" high front glass display section

	QTY.	DISCOUNT	STANDARD	TOTAL
Full Corner Vision Case	_____	\$400.00	\$450.00	\$ _____
1/2 Corner Vision Case	_____	\$375.00	\$425.00	\$ _____
1/4 Corner Vision Case	_____	\$375.00	\$425.00	\$ _____

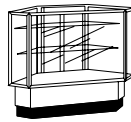

Full Corner Vision Case

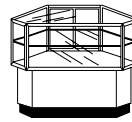

1/2 Corner Vision Case

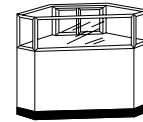

1/4 Corner Vision Case

## WALL & TOWER CASE

Wall Case Includes  
48"L x 20"D x 66"H, with 4-12" glass shelves,  
adjustable brackets, lights, locks and 60" high  
sliding glass doors

Tower Case Includes  
20"L x 20"D x 80"H, with 3 glass shelves,  
lights and locks

	QTY.	DISCOUNT	STANDARD	TOTAL
Solid Wall Case	_____	\$400.00	\$450.00	\$ _____
See-Thru Wall Case	_____	\$400.00	\$450.00	\$ _____
Tower Case	_____	\$400.00	\$450.00	\$ _____

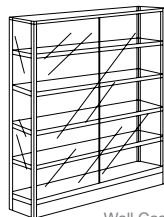

Wall Case

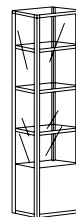

Tower Case

ORDER TOTAL \$ \_\_\_\_\_

## ADDITIONAL INFORMATION

- All showcases are 20" D x 38" H, have lights, locks, sliding mirror doors, grey exterior, off-white interior aluminum frames.
- 4' showcases available upon request. (limited quantities)
- Electrical hook-up is not included. Please order the outlet from electrical contractor.
- A \$50.00 charge per showcase for late orders and changes made at show site.
- All keys must be left with showcase or a charge of \$10.00 will be assessed.
- A \$20.00 charge per additional shelf or size change of shelf.

Company Name: \_\_\_\_\_ Phone #: \_\_\_\_\_ Fax #: \_\_\_\_\_

Address: \_\_\_\_\_ City: \_\_\_\_\_ State: \_\_\_\_\_ Zip: \_\_\_\_\_

Authorized By (print): \_\_\_\_\_ Signature: \_\_\_\_\_ Booth #: \_\_\_\_\_

Order Summary and Payment Sheet MUST accompany this order. All terms and conditions as outlined on the Order Summary and Payment Sheet have been reviewed and understood.

RES Address: 9291 West Bryn Mawr, Rosemont, IL 60018 • RES Telephone: 847-696-2208 • RES Fax: 847-696-9797